

**PALFINGER TAIL LIFTS**

# **PALFINGER REMOTE CONTROL BT**

**OPERATING MANUAL**



**with PALFINGER IMPACT APP**

SAP Material Status

**Operating manual**  
for  
**PALFINGER Remote Control BT**  
and  
**PALFINGER IMPACT App**

## Table of contents

<b>1. About this manual .....</b>	<b>6</b>
1.1. Further documentation .....	6
<b>2. Manufacturer information .....</b>	<b>6</b>
<b>3. Important safety information .....</b>	<b>6</b>
3.1. Intended use .....	7
3.2. Personnel qualifications .....	8
3.3. Safety notes for use .....	8
3.4. Warnings in this manual.....	9
3.5. You must observe these points:.....	10
3.5.1. General information .....	10
3.5.2. During operation .....	10
3.5.3. Before maintenance.....	10
<b>4. Package contents .....</b>	<b>10</b>
4.1. <b>PALFINGER</b> Remote Control BT Transmitter.....	11
4.1.1. Description .....	12
4.1.2. Technical data .....	12
4.2. <b>PALFINGER</b> Remote Control BT Receiver.....	13
4.2.1. Description .....	13
4.2.2. Technical data .....	13
<b>5. Mounting and electrical connection .....</b>	<b>14</b>
5.1. Prerequisites .....	14
5.2. Mounting the receiver .....	15
5.3. Electrical connection .....	16
5.4. Receiver cable wire assignment .....	17
<b>6. Commissioning and operation .....</b>	<b>17</b>
6.1. General notes regarding commissioning and operation.....	17
6.2. Charging the transmitter battery.....	18
6.3. Switching on and off.....	19

- 6.4. Coupling the transmitter with a receiver (pairing) ..... 20
  - 6.4.1. Activating pairing mode on the receiver..... 20
  - 6.4.2. Activating pairing mode on the transmitter and pairing..... 21
  - 6.4.3. Deleting/removing paired receivers ..... 22
- 7. Operation ..... 23**
  - 7.1. Switching on the transmitter ..... 23
  - 7.2. Button 2(A) and 3(B)..... 23
  - 7.3. Buttons 4 to 7 ..... 23
  - 7.4. Two paired receivers ..... 24
- 8. Maintenance and cleaning..... 24**
- 9. Faults ..... 24**
  - 9.1. Malfunction due to exceeding the transmitter range ..... 24
  - 9.2. Status and fault messages ..... 25
    - 9.2.1. Status messages on the transmitter ..... 25
    - 9.2.2. Status messages on the receiver ..... 26
    - 9.2.3. Fault codes and rectification ..... 27
- 10. Replacing the belt clip with the cover plate ..... 28**
- 11. Disposal ..... 28**
- 12. Warranty..... 29**
- 13. Simplified declaration of conformity ..... 29**
- 14. The PALFINGER IMPACT App ..... 30**
  - 14.1. Overview..... 30
  - 14.2. Installation ..... 31
    - 14.2.1. Installing the **PALFINGER IMPACT** app on your smartphone ..... 31
    - 14.2.2. Connecting the **PALFINGER IMPACT** App to your tail lift..... 31
  - 14.3. Other displays and functions ..... 33
- 15. Connection diagram ..... 34**

## 1. About this manual

This document is a supplement to the existing operating instructions with special instructions for the **PALFINGER** Remote Control BT and the **PALFINGER** IMPACT App and must always be used in conjunction with these operating instructions.

This manual contains important information on the safe and proper mounting, operation, maintenance of the **PALFINGER** Remote Control BT and also how to independently rectify simple faults.

Read these instructions all the way through, particularly the chapter Important safety information, before working with the lifting platform.

### 1.1. Further documentation

- Operating instructions (standard)
- Installation instructions
- Installation drawing
- Spare parts catalogue (online, [www.eetk.eu](http://www.eetk.eu))
- Test book
- Installation examination (on request)

## 2. Manufacturer information

The Bluetooth® trademark and logos are registered trademarks of the Bluetooth SIG, Inc. and any use of such marks by **PALFINGER Tail Lifts** is under license.

## 3. Important safety information

The **PALFINGER** Remote Control BT has been built according to the current state-of-the-art and to recognised safety engineering rules. Nevertheless there is a danger of personal injury and material damage if you do not comply with the following general safety instructions and the warnings in this manual.

- For this reason, read these instructions thoroughly and completely before operating the tail lift with the **PALFINGER** Remote Control BT.
- Keep the manual on hand so that it is accessible for all users at any time.

- If you sell or lend the vehicle with the tail lift, always include this instruction manual.

### **3.1. Intended use**

- The transmitter and receiver may only be mounted, connected, maintained, repaired and commissioned by trained personnel.
- In order to prevent misuse and hazards, never leave the transmitter unsupervised.
- When using the transmitter, the working area must be within the view of the operator.
- Do not open, modify or disassemble the transmitter or receiver under any circumstances. This can result in electric shock, malfunction or fire.
- Do not expose the transmitter or receiver to mechanical pressure. This can result in electric shock, malfunction or fire.
- Do not operate the transmitter and receiver in an environment containing flammable gases, vapours or solvents that do not comply with the requirements of GGVS/ADR 2019. This increases the risk of fire and explosion.
- Do not use the transmitter and receiver if they are damaged. This can result in material damage or injuries.
- Do not use the transmitter and receiver if there is a malfunction or if they do not work at all. This can result in material damage or injuries.
- Do not use the transmitter and receiver if there is smoke, a burning odour, or if the transmitter or receiver becomes discoloured. This can result in material damage or injuries.
- Do not cover the transmitter and receiver with a cloth (or similar). This can result in fire or injury from overheating.
- Dispose of the packaging material properly.

### 3.2. Personnel qualifications

The tail lift may only be operated:

- Anyone who has read and understood these instructions and in particular the chapter "Important safety information" and the general operating instructions
- and has familiarised themselves with the operation and handling of the tail lift.

### 3.3. Safety notes for use

- Losses and damage caused by failure to comply with the safety requirements shall not be covered by the warranty. The manufacturer shall not be liable for consequential damage.
- The **PALFINGER** Remote Control BT may not be used to operate systems/applications for which the user is not protected by the system's own security functions.
- The manufacturer shall not be liable for damage to property or personal injury caused by improper operation or failure to comply with safety regulations. In such cases the warranty will also be rendered null and void.
- When mounting the receiver, ensure that the connection cables are not pinched, kinked or otherwise damaged (e.g. by sharp edges).
- If you have any questions about the operation, safety or commissioning of the transmitter and receiver, contact a specialist.
- Ensure that the receiver is neither mechanically nor electrically overloaded. This may damage the receiver and cause fire or electric shock.
- Only use the receiver in the voltage range from 9 to 36 volts (DC). The load of the entire system must not exceed a maximum total current of 1,7 amperes. Provide additional protection for the power supply.
- If the receiver is visibly iced up, never remove the ice by force.  
Observe the safety regulations, the applicable laws and the warnings in the operating instructions of the tail lift.

### 3.4. Warnings in this manual

In this manual, safety instructions precede a procedure which incurs risks of personal injury or material damage.

Warnings are structured as follows:



**SIGNAL WORD!**

- Description of type and source of the danger
- Description of consequences of non-observance
- ▶ Description of measures for avoiding danger

It is essential that the measures described to avert danger are complied with!

The signal word indicates the severity of the danger:

Signal word	Application
<b>DANGER!</b>	Indicates a danger that will certainly result in death or severe injury if you fail to avoid it.
<b>WARNING!</b>	Indicates a danger that may result in death or severe injury if you fail to avoid it.
<b>CAUTION!</b>	Indicates a danger that may result in minor to moderate injuries if you fail to avoid it.
<b>Note:</b>	If you do not observe this information, the assembly or operating process may be adversely affected.



### 3.5. You must observe these points:

#### 3.5.1. General information

- Always carry these instructions with you in the vehicle.
- Structural modifications may only be performed by **PALFINGER Tail Lifts** contract workshops. You can find your nearest authorised workshop and further contact information in the workshop directory at [www.palfinger.com](http://www.palfinger.com) and via the **PALFINGER IMPACT** app (see chapter 14, page 30).
- Use only original parts from **PALFINGER Tail Lifts** during maintenance work.
- Observe all applicable accident prevention regulations.

#### 3.5.2. During operation

- Ensure there is sufficient lighting in the loading area.
- Never carry people on the tail lift.
- Keep the movement area around the vehicle clear.

#### 3.5.3. Before maintenance

- Switch off the battery main switch or remove the earth strap.
- When carrying out maintenance work under the platform, secure the lifting gear against downward movement.

## 4. Package contents

- **PALFINGER** Remote Control BT transmitter, see chapter 4.1, page 11
- **PALFINGER** Remote Control BT receiver with 6-wire connection cable (length: 4 m, depending on type), see chapter 4.2, page 13
- USB-C to USB-A charging cable (1.0 m)
- Bracket for the Remote Control BT transmitter
- Fastening material
- Operating manual

### 4.1. PALFINGER Remote Control BT Transmitter

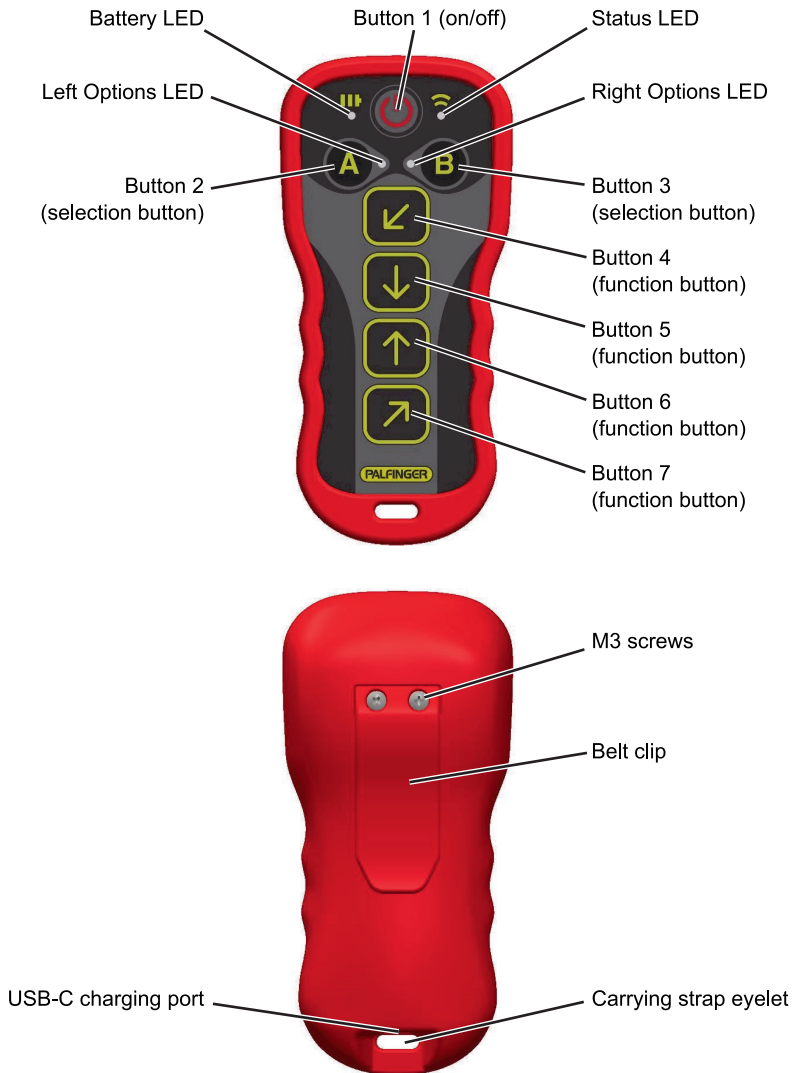

#### 4.1.1. Description

The **PALFINGER** Remote Control BT Transmitter is a Bluetooth radio remote control transmitter with two selection buttons and four operating buttons. The **PALFINGER** Remote Control BT transmitter is used to control the associated Bluetooth 5.0 receiver. This receiver can read in and process digital signals. The LEDs on the transmitter indicate status and error messages (see chapter 9, page 24).

#### 4.1.2. Technical data

- Operation: Membrane keyboard with 1 On/Off key, 2 selection and 4 function keys
- Visual feedback: 4 RGB LEDs
- Frequency: 2.4 GHz (Bluetooth 5.0)
- Response time: approx. 50 ms
- Antenna: internal
- Transmitting power: +8 dBm
- Working range: approx. 10 m (dependent on surrounding conditions)
- Power consumption: approx. 60 mA when switched on
- Power supply: nominal 3.7 VDC (internal rechargeable battery)
- Rechargeable battery type: Lithium ion polymer rechargeable battery
- Battery capacity: 1350 mAh ( $\geq 80\%$  after 300 charging cycles;  $\geq 60\%$  after 500 charging cycles)
- Charging port: USB-C
- Dimensions/weight (including belt clip):  
137 mm x 65 mm x 35 mm (L x W x H)/113g
- Housing material: ABS
- Protection class: IP67
- Temperature range:  $-20^{\circ}\text{C}$  to  $+50^{\circ}\text{C}$
- Max. working altitude: 2000 m above sea level
- Min. system requirements: **PALFINGER** Remote Control BT Receiver (Bluetooth 5.0)

## 4.2. PALFINGER Remote Control BT Receiver

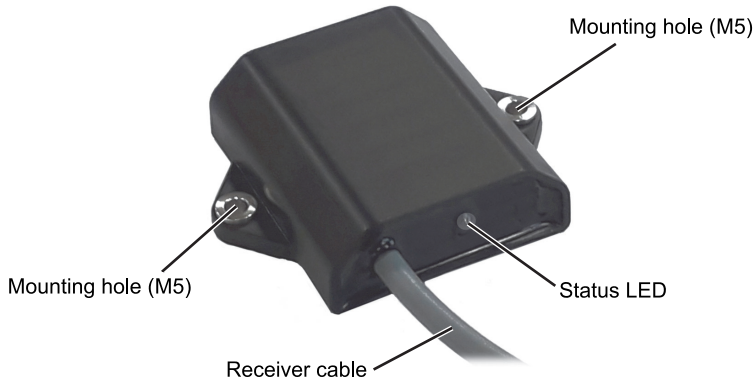

### 4.2.1. Description

The **PALFINGER** Remote Control BT receiver is a Bluetooth 5.0 radio control receiver with CAN bus interface. Communication between the receiver and the control system of the **PALFINGER** tail lift takes place via the CAN bus interface. The receiver is controlled via the transmitter of the **PALFINGER** Remote Control BT. The status LED indicates status and fault messages (see chapter 9, page 24).

The use of this receiver is a prerequisite for the use of the **PALFINGER** IMPACT App (see chapter 14, page 30).

### 4.2.2. Technical data

- Frequency: 2.4 GHz (Bluetooth 5.0)
- Antenna: internal
- Transmitting power: +8 dBm
- Working range: approx. 10 m, dependent on surrounding conditions
- Supply voltage: 8 to 32 VDC
- Power consumption: < 8 mA (Standby)
- Electrical connections:  
CAN bus (2 lines), range limitation, CAN bus monitoring and power supply via J3 and JP plugs
- Max. output current: 1.7 A

- Dimensions/weight:  
72 mm x 88 mm x 24 mm (L x W x H)/410g including cable
- Housing: moulded ABS housing (IP67)
- Temperature range: -40°C to +60°C
- Max. working altitude: 2000 m above sea level
- Visual feedback: two-colour LED (red/green)

## 5. Mounting and electrical connection

### 5.1. Prerequisites



#### **WARNING!**

Improper installation and incorrect electrical connection can lead to malfunctions, resulting in risks of injury and property damage.

- ▶ Installing and establishing the electrical connections for the receiver when tired or under the influence of drugs or medication is strictly prohibited.
- ▶ Comply with the safety regulations below.

- The receiver may be installed, connected and operated only by qualified personnel as a matter of principle.
- When installing and establishing the electrical connections for the receiver, make sure the working/installation environment is clean, tidy and dry.
- Before mounting and electrically connecting the receiver, the tail lift must be disconnected from the power supply.
- Please always follow the supplied wiring diagrams.
- Connect the wires with the correct cable connectors and do not use insulating tape.

Always comply with the applicable safety regulations.

## 5.2. Mounting the receiver

- ▶ Select a suitable mounting position:
  - Choose a mounting position with sufficient distance to objects that can affect the reception strength.
  - If possible, mount the receiver in sight of the user. Do not mount the receiver in the immediate vicinity of motors, relays or mains cables.
  - Do not mount the receiver on the inside of a metal housing.

**Note:**

**PALFINGER** recommends mounting the receiver on one of the brackets of the Slimpanel (see illustration below).

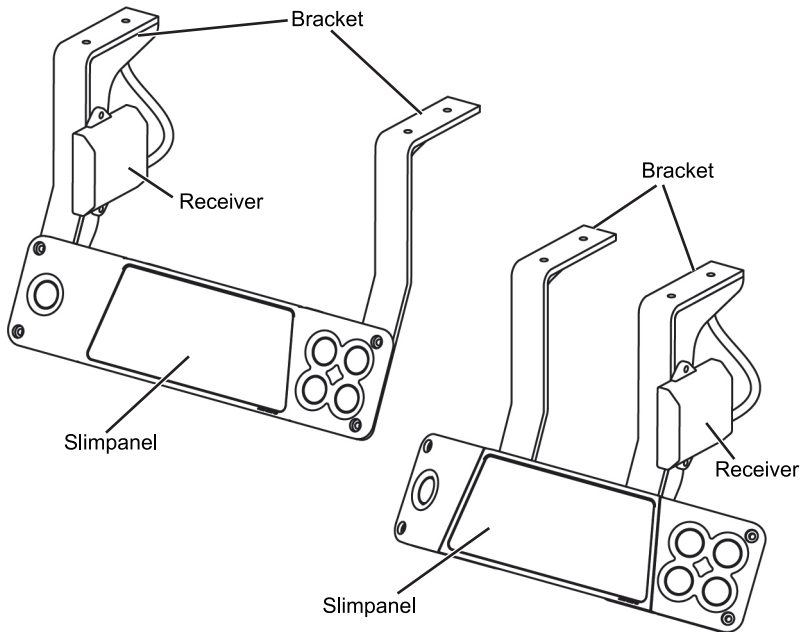

- ▶ Secure the receiver with two M5 screws.
- ▶ Route the receiver cable to the control board of the tail lift. Secure the cable sufficiently. Make sure that the cable cannot be damaged by movements of the tail lift or other vehicle parts.

### 5.3. Electrical connection



#### CAUTION!

Fire or electric shock may occur when making the electrical connection. A poorly executed electrical connection leads to malfunctions, which can result in risk of injury and damage to property.

- ▶ The electrical connection may only be carried out by qualified electricians or under their supervision.
- ▶ Disconnect the power supply for the lifting platform.
- ▶ Only then carry out the electrical connection.

#### Note:

Also read the user manual of the devices to be connected to the receiver and follow their safety instructions.

Observe the wiring diagram of the receiver on page 34.

#### Note:

Only use the receiver in the voltage range from 9 to 36 volts (DC). Provide additional protection for the power supply.

- ▶ Switch off the power supply to the tail lift control board, e.g. by disconnecting the battery ground cable.

The receiver is fitted with plugs (J3/JP) as standard.

- ▶ Plug the connectors J3 and JP into the corresponding slots on the control board (see wiring diagram on page 34).

If slot J3 on the control board is occupied:

- ▶ Unplug the connector present in the slot.
- ▶ Plug the connector J3 of the receiver into the slot.
- ▶ Insert the plug that was previously there into the socket on the receiver cable.
- ▶ Check that plugs J3 and JP are correctly plugged in.
- ▶ Re-establish the power supply for the lifting platform.

## 5.4. Receiver cable wire assignment

Wire colour	Assignment on the control board
White	Slot JP, CAN L terminal
Green	Slot JP, CAN H terminal
Yellow	Slot J3, terminal 4
Blue	Slot J3, terminal 4
Black	Slot J3, terminal 5
Brown	Slot J3, earth terminal

## 6. Commissioning and operation

### 6.1. General notes regarding commissioning and operation



#### **WARNING!**

Risk of injury and material damage due to incorrect commissioning and operation!

- ▶ Commissioning and operating the transmitter when tired or under the influence of drugs or medication is strictly prohibited.
- ▶ Comply with the safety regulations below.

- The transmitter may only be commissioned and operated by qualified personnel.
- Improper commissioning or operation can endanger the user, bystanders as well as other persons concerned (depending on the application). Injuries and material damage are possible.
- When commissioning and operating the transmitter, make sure the working environment is as clean, tidy and dry as possible.
- During commissioning and operation, always maintain a sufficient distance from objects that could affect the transmission/reception strength.
- Always comply with the applicable safety regulations.
- Make sure that the battery is sufficiently charged before commissioning and operating the transmitter (see chapter 6.2, page 18).
- Before switching on for the first time, make sure that the **PALFINGER** Remote Control BT receiver plugs are correctly plugged into the tail lift control board.



## 6.2. Charging the transmitter battery



### Caution!

Risk of injury and material damage due to improper charging of the transmitter battery!

Charging outside the appropriate temperature range will damage the transmitter and may cause injury to persons.

- ▶ Only charge the transmitter battery at ambient temperatures between +5° and +35°.

- Incorrect connection of the charging cable can cause damage to the transmitter. Damage caused by improper use is not covered by the warranty.
- Only use the USB cable supplied with the transmitter.
- Ensure that the USB cable is not kinked or otherwise damaged.
- Do not charge the transmitter battery for longer than necessary, as overcharging may affect the battery life.
- To protect against corrosion and damage, carefully clean and dry the contacts of the charging socket and the surrounding area before connecting the charging cable.
- The battery is permanently installed and cannot be replaced.

### Note:

It is not possible to operate the transmitter during the charging process.



- ▶ Connect the USB-A connector (see illustration above) of the USB cable to a suitable USB power supply unit (with charging connection in accordance with USB specification).
- ▶ Connect the USB-C connector (see illustration above) of the USB cable to the charging socket provided on the bottom of the transmitter (see illustration on page 11).
- ▶ Plug the USB power adapter into a suitable mains socket.
- ▶ Disconnect the USB cable from the transmitter as soon as the battery is fully charged (see chapter 9.2.1, page 25).
- ▶ Remove the USB power adapter from the mains socket.

**Proceed as follows if the transmitter overheats during charging:**

- ▶ Disconnect the charging cable from the transmitter. Wait until the transmitter cools down and then continue charging.

If the lower part of the transmitter overheats, this may be because the USB cable is damaged. In this case:

Replace the damaged USB cable with a new USB cable approved by **PALFINGER Tail Lifts**.

**6.3. Switching on and off**

- ▶ Make sure that the battery is sufficiently charged before commissioning and operating the transmitter.
- ▶ Bring the transmitter towards the receiver, until the distance between them is  $\leq 2$  m.

- ▶ Press the 1 button (On/Off) for 2 seconds to switch on the transmitter (see illustration on page 11).

After successfully switching on the transmitter, the Battery LED indicates the charging status of the battery (refer to chapter 9.2.1, page 25).

If the transmitter has already been paired with a receiver before, the transmitter automatically connects with the receiver. The status LED of the transmitter lights up steadily green.

- ▶ Press Button 1 again to switch the transmitter off again.

The Battery LED going out indicates that the transmitter is switched off.

**Note:**

Please note that this does not switch off the receiver and that it remains ready to receive since it has its own power supply. However, any active outputs on the receiver are deactivated by switching off the transmitter (safety function).

**Note:**

If no transmitter button is pressed for a prolonged period of time (> 10 minutes), the transmitter switches off automatically to save power.

- ▶ To switch on the transmitter again, press and hold button 1 for 2 seconds.

## 6.4. Coupling the transmitter with a receiver (pairing)

To pair the transmitter with a receiver, the pairing mode must be activated on the transmitter and the receiver.

### 6.4.1. Activating pairing mode on the receiver

When operating the tail lift via a Slimpanel:

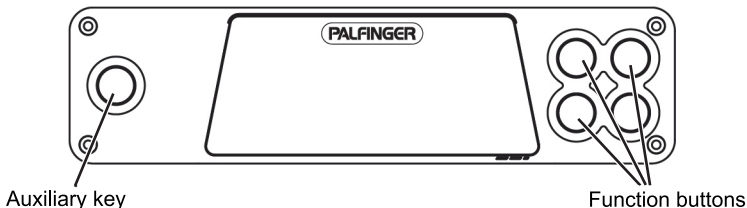

- ▶ Press the auxiliary key and any three function keys on the Slimpanel for at least 10 seconds.

When operating the tail lift via a control panel:

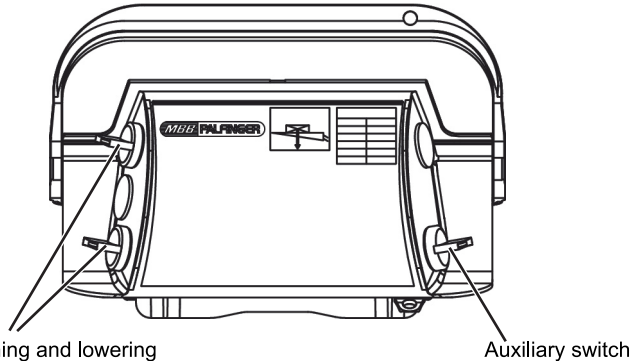

- ▶ On the control panel, turn the open and lower switches and the auxiliary switch down for at least 10 seconds.

When pairing mode is activated, the status LED on the receiver flashes red and green alternately.

**Note:**

To pair the **PALFINGER IMPACT** App with the receiver, you must also activate the pairing mode on the receiver (see chapter 14, page 30).

#### 6.4.2. Activating pairing mode on the transmitter and pairing

- ▶ Bring the transmitter towards the receiver, until the distance between them is  $\leq 2$  m.

To activate pairing mode on the transmitter, the following sequence of buttons must be pressed within a maximum of 5 seconds:

- ▶ With the transmitter switched off, press button 1 (On/Off) until the status LED starts to flash orange (max. 3 seconds).
- ▶ Release the 1 (On/Off) button and press it again twice in quick succession.

The Status LED now flashes red and green alternately. If a receiver is found that is in pairing mode, the transmitter automatically connects to it. As soon as the pairing process has been successfully completed and the transmitter has connected to the receiver, the Status LED lights up steadily blue.

Press the 1 (On/Off) button to turn off the transmitter and exit pairing mode.

**Note:**

The pairing mode corresponds to the service mode or emergency mode of the tail lift (see operating instructions). The tail lift sensors are not interrogated. The functions for opening, lowering, lifting and closing can be performed without automatic function.

Further possibilities to leave the pairing mode or emergency mode again:

- ▶ Switch the tail lift off and on again at the switch in the driver's cab.

or:

- ▶ Use the same key combination on the Slimpanel or control panel as for activating the pairing mode (see chapter 6.4.1, page 20).

or:

- ▶ Exit the pairing mode via the "Disable Service Mode" button on the **PALFINGER IMPACT** app (see chapter 14.3, page 33).

### 6.4.3. Deleting/removing paired receivers

To delete all paired receivers from the transmitter's memory, the following combination of buttons must be pressed within a maximum period of 9 seconds:

- ▶ With the transmitter switched off, press button 1 (On/Off) until the status LED starts to flash orange (max. 3 seconds).
- ▶ Release the 1 (On/Off) button and press it again six times in quick succession.

The Status LED flashes red and blue alternately, indicating that all paired receivers have been deleted from the transmitter's memory.

- ▶ Press Button 1 to turn off the transmitter.

## 7. Operation

The standard functions of the transmitter are described below. Depending on the configuration delivered, the functions of the keys may differ.

### Note:

The **PALFINGER** Remote Control BT only works when a certain distance is maintained between the transmitter and receiver. Operation will not be possible if this distance is exceeded. This will be indicated to the user by the status LED on the transmitter, which will light up orange continuously. Refer in this regard to chapter 9.2.1, page 25.

### 7.1. Switching on the transmitter

- ▶ Switch on the tail lift (see tail lift operating instructions)
- ▶ Bring the transmitter towards the receiver, until the distance between them is  $\leq 2$  m.
- ▶ Switch on the transmitter (see chapter 6.3, page 19).

### 7.2. Button 2(A) and 3(B)

The respective functions of the receiver are controlled with Buttons 2 (A) and 3 (B, see illustration on page 11). The associated function is only executed as long as the respective button is pressed. As soon as a button is released, the associated function is stopped.

- ▶ Press Button 2 (A) to activate the Extend or Lower Props function (depending on the application).
- ▶ Press Button 3 (B) to activate the Retract or Raise Support function (depending on the application).

### 7.3. Buttons 4 to 7

The respective functions of the receiver are controlled with buttons 4 to 7 (see illustration on page 11). The associated function is only executed as long as the respective button is pressed. As soon as a button is released, the associated function is stopped.

- ▶ Press button 4 to open the platform.
- ▶ Press Button 5 to lower the platform.
- ▶ Press Button 6 to raise the platform.
- ▶ Press Button 7 to close the platform.

**Note:**

If the connection is interrupted, the Status LED starts flashing orange. Any active functions are stopped.

## 7.4. Two paired receivers

### Button 2(A) and 3(B)

Buttons 2(A) and 3(B, see illustration on page 11) are assigned with selection functions if an application with two paired receivers is present. In this case, you can switch between Receivers 1 and 2 with Buttons 2 (A) and 3 (B).

Press Button 2 (A) to select Receiver 1. The corresponding functions of Receiver 1 can now be controlled using Buttons 4 to 7.

Press Button 3 (B) to select Receiver 2. The corresponding functions of Receiver 2 can now be controlled using Buttons 4 to 7.

## 8. Maintenance and cleaning

The transmitter and receiver are maintenance-free for the user. Maintenance and repairs must be carried out by a specialist. Clean the transmitter and the receiver only with a damp cloth and without chemicals. Otherwise the transmitter and the receiver may be damaged. It is advisable to clean the transmitter once a week. If the transmitter is to be used in a very dirty environment, e.g. dusty, daily cleaning is recommended in order to avoid damage arising as a result.

## 9. Faults

### 9.1. Malfunction due to exceeding the transmitter range

Once the tail lift has been switched on, it is necessary to bring the **PALFINGER** Remote Control BT transmitter to a distance of  $\leq 2$  m from the receiver. This is necessary one time only. Afterwards, operation from a greater distance will be possible (within the specified range).

If the specified range is exceeded, operation will not be possible. The status LED on the transmitter will light up orange continuously.

In this case:

- ▶ Bring the transmitter close to the receiver again until the status LED on the transmitter lights up green continuously.

## 9.2. Status and fault messages

The current status and faults are indicated by a flashing sequence of LEDs on the transmitter and receiver. Faults can be diagnosed and remedied using the list in chapter "Fault codes and rectification", page 27.

### 9.2.1. Status messages on the transmitter

#### Battery LED

Flashing sequence/colour	Meaning
Off	Transmitter switched off, system not active
Steadily on (green)	Transmitter switched on, battery charge between 40% and 100%
Steadily on (orange)	Transmitter switched on, battery charge between 20% and 40%
Steadily on (red)	Transmitter switched on, battery charge between 10% and 20%
Normal flashing (red)	Transmitter switched on, battery charge between 1% and 10%
Charging:	
Flashing (purple)	Transmitter switched off, battery charging
Steadily on (purple)	Transmitter switched off, battery charging complete battery charge 100%

#### Status LED

Flashing sequence/colour	Meaning
Off	Transmitter switched off, system not active
Normal flashing (red/green)	Pairing mode is active, transmitter ready for coupling with receiver



<b>Flashing sequence/colour</b>	<b>Meaning</b>
Slow flashing (orange)	Not connected to receiver
Steadily on (orange)	Connected to receiver, connection active, no operation possible (transmitter range exceeded, see chapter 9.1, page 24)
Rapid flashing (green)	When button pressed/active control
Steadily on (orange-yellow)	A second transmitter is connected to the receiver and is active
Flashing sequence (red)	Fault (see chapter "Fault codes and rectification", page 27)

### Left Options LED

<b>Flashing sequence/colour</b>	<b>Meaning</b>
Off	Receiver 1 not selected
Steadily on (green)	Receiver 1 selected

### Right Options LED

<b>Flashing sequence/colour</b>	<b>Meaning</b>
Off	Receiver 2 not selected
Steadily on (green)	Receiver 2 selected

**Note:**

The "Right Options LED" is only used for applications where two receivers are used

### 9.2.2. Status messages on the receiver

<b>Flashing sequence/colour</b>	<b>Meaning</b>
Off	No power supply

Flashing sequence/colour	Meaning
Slow flashing (green)	Receiver switched on and ready to connect to a transmitter already taught-in
Steadily on (green)	Receiver switched on and connected to transmitter
Normal flashing (red/green)	Pairing mode: Receiver switched on and ready to learn a new transmitter
Flashing sequence (red)	Fault (see chapter "Fault codes and rectification")

### 9.2.3. Fault codes and rectification

Flashing sequence	Error	Solution:
2 x short	Receiver undervoltage (< 6.5 V for 1.5 s)	Charge the vehicle battery.
3 x short	Receiver overvoltage > 36 V for 60 ms)	Disconnect the receiver from the power supply. Eliminate the cause of the overvoltage. Reconnect the receiver to the power supply.
4 x short	Receiver overtemp (> 85°C for 1 s)	Move the mounting location of the receiver to a well ventilated area so that an over-temperature situation can be avoided.
5 x short	The transmitter is not compatible and is not recognised by the receiver.	Contact <b>PALFINGER</b> Customer Service and replace the transmitter.
6 x short	Failure of the safety signal in the CAN bus line for ≥ 200 ms.	Disconnect and reconnect the vehicle battery to trigger a restart of the receiver and the tail lift controller.
1 x long, 1 x short	Overcurrent at output 1 of the receiver	Check the current consumption of the connected component. Check the receiver cable for damage.
2 x long, 1 x short	Hardware or software error in the receiver	Contact <b>PALFINGER</b> Customer Service and replace the receiver.

<b>Flashing sequence</b>	<b>Error</b>	<b>Solution:</b>
2 x long, 2 x short	Unexpected internal reboot.	Switch the tail lift off and on again at the switch in the driver's cab.
2 x long, 3 x short	Hardware fault	Contact <b>PALFINGER</b> Customer Service and replace the receiver.
Con- tinuously flashing	Fault detected by the safety loop.	Contact <b>PALFINGER</b> Customer Service and replace the receiver.

## 10. Replacing the belt clip with the cover plate

The transmitter comes from the factory complete with a pre-mounted belt clip. If necessary, you can replace this with the cover plate, which is also included in the delivery, so that the back of the transmitter is flat. To do this, proceed as follows:

- ▶ Using a suitable Phillips screwdriver, carefully loosen the two screws securing the belt clip to the back of the transmitter. Remove the belt clip.
- ▶ Place the cover plate in the recess provided on the back of the transmitter. Make sure that the countersunk holes of the cover plate are facing you.
- ▶ Fasten the cover plate with the supplied countersunk screws. Take care not to overscrew or overtighten the screws (max. 0,6 Nm) as this may cause internal damage to the housing and thus loss of IP67 protection rating.

## 11. Disposal

Electronic devices are recyclable waste and do not belong in the household waste. If the transmitter or receiver no longer functions, dispose of the corresponding component in accordance with the applicable, country-specific legal regulations. With the aforementioned recommendation, you fulfil your legal obligations and contribute to protecting the environment.

## 12. Warranty

The transmitter has been tested in a controlled environment and has proven to be resistant to moisture and dust under certain conditions (meets the requirements of IP67 classification according to the international standard IEC 60529).

The receiver has been tested in a controlled environment and has proven to be resistant to moisture and dust under certain conditions (meets the requirements of IP69k classification per international standard IEC 60529).

It is not possible for the supplier/manufacturer to ensure that the contents of this operating manual and use of the transmitter are understood and followed by the user. Improper or faulty installation or assembly and improper or faulty operation can lead to injuries and damage to the materials.

The manufacturer accepts no liability for damage resulting from improper or incorrect mounting or use. This also applies to damage caused by incorrect maintenance or the failure to carry out maintenance. Any unauthorised disassembly or modification shall indemnify the manufacturer from any responsibility. All parts must be approved by the manufacturer so that the transmitter and receiver maintain guaranteed safety and operation over their lifetime.

## 13. Simplified declaration of conformity

**PALFINGER Tail Lifts** GmbH, Fockestr. 53, 27777 Ganderkesee, Germany, that the radio system type **PALFINGER** Remote Control BT complies with Directive 2014/53/EU.

The complete declaration of conformity can be found at

[https://www.palfinger.com/importdata/emea/products/tail-lifts/brochures/Konformitaetserklaerung/Konformitaetserklaerung\\_tail-lift-qr-code.pdf](https://www.palfinger.com/importdata/emea/products/tail-lifts/brochures/Konformitaetserklaerung/Konformitaetserklaerung_tail-lift-qr-code.pdf)

or via the following QR code:



## 14. The PALFINGER IMPACT App

With the **PALFINGER IMPACT** app, you can read out the current status of your tail lift, determine the cause of a fault in the event of a malfunction and find the nearest **PALFINGER** service partner. You can also activate the emergency mode to restore the driving ability of your vehicle in the event of a malfunction of the tail lift controller.

### 14.1. Overview

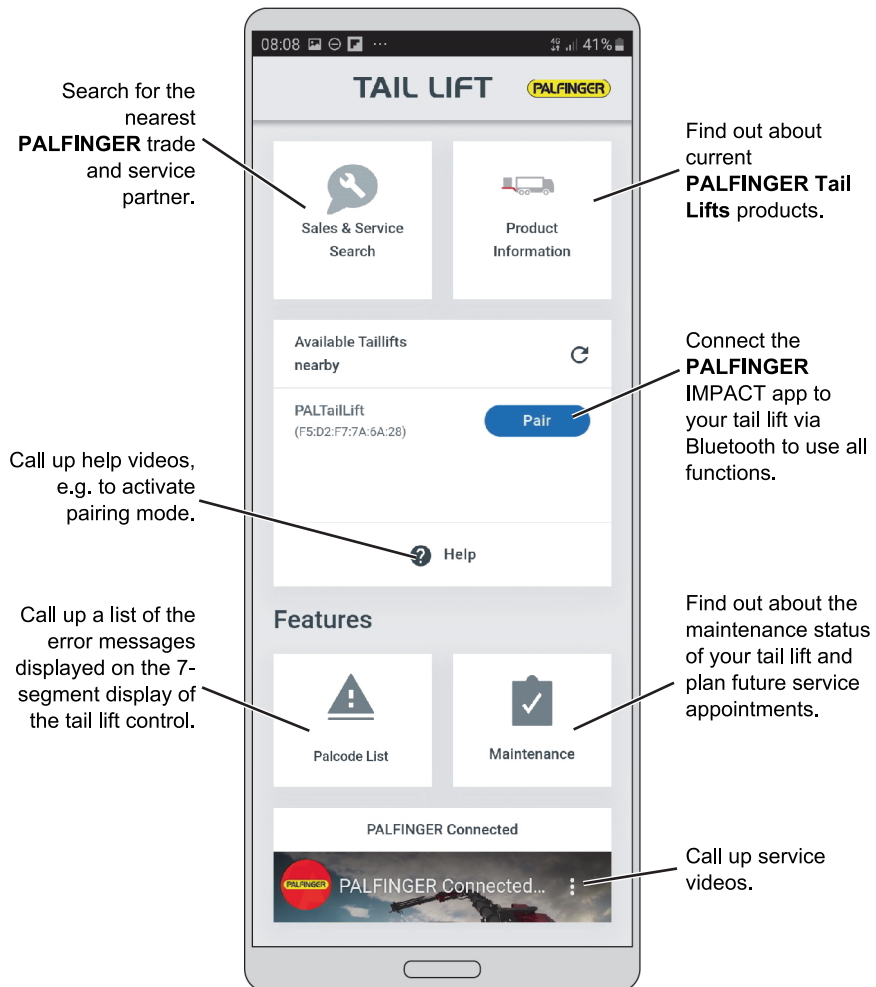

## 14.2. Installation

### 14.2.1. Installing the PALFINGER IMPACT app on your smartphone

- ▶ Open the Apple App Store or the Google Play Store, depending on your smartphone type.
- ▶ Search for the **PALFINGER IMPACT** app in the Store.
- ▶ Tap on "Install".
- ▶ Follow the instructions on the display to install the **PALFINGER IMPACT** App.

### 14.2.2. Connecting the PALFINGER IMPACT App to your tail lift

- ▶ Make sure that Bluetooth and location tracking are activated on your smartphone.

The app displays the receiver of the Remote Control BT (see illustration below).

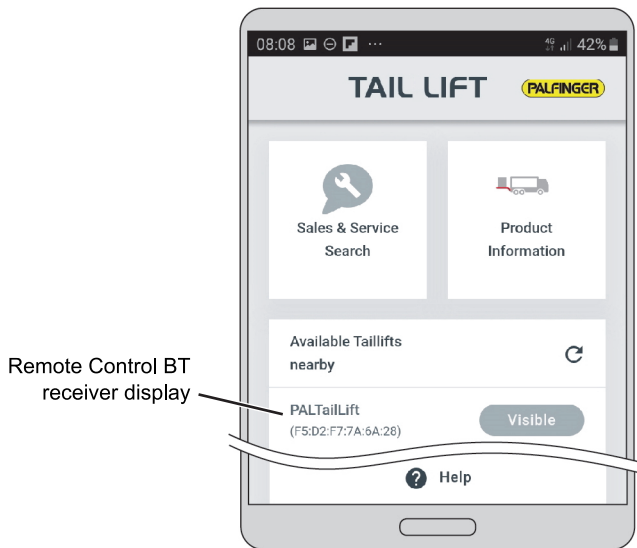

- ▶ Activate the pairing mode on the receiver (see chapter 6.4.1, page 20).
- ▶ Tap the "Pair" button to connect the **PALFINGER IMPACT** App with the receiver of the Remote Control BT (see illustration next page).

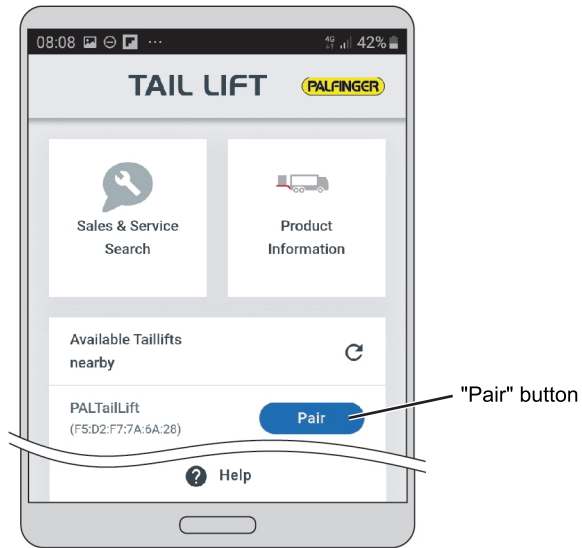

The **PALFINGER IMPACT** App is now connected to the receiver of the Remote Control BT and displays tail lift data (see chapter 14.3, page 33).

For the next connection of the **PALFINGER IMPACT** App with the receiver:

- ▶ Tap the "Paired" button (see illustration below).



### 14.3. Other displays and functions

